

## Transtibial Alignment Kit, Child

---

### Instructions for Use

Please read this document carefully and follow the safety instructions.

Item codes: see bottom of document





Functions and benefits.....	5
Intended use .....	5
Residual risks, contraindications .....	5
Device specifications.....	6
Training.....	6
Storage/handling .....	6
Environmental conditions .....	7
Included in delivery.....	7
Device manufacturing and setup guidelines .....	7
Maintenance.....	16
Cleaning and care .....	16
Disposal .....	17
Reusability .....	17
Compatibilities .....	18
Spare parts.....	18
Warnings, precautions .....	18
Compliance .....	19
CE Conformity.....	19
Item codes .....	19
IFU ID and date .....	19



## Functions and benefits

The Rehab'Impulse Transtibial Alignment Kit, Child permits prosthetic fitting for various levels of amputation of the lower extremities. The transtibial alignment kit consists of a set of components allowing different alignment configurations.

## Intended use

This product is intended for prosthetic fitting of children. This product is not intended for excessive physical activities. Approved for a body weight of up to 60 kg (P3)

## Residual risks, contraindications

n/a

## Device specifications

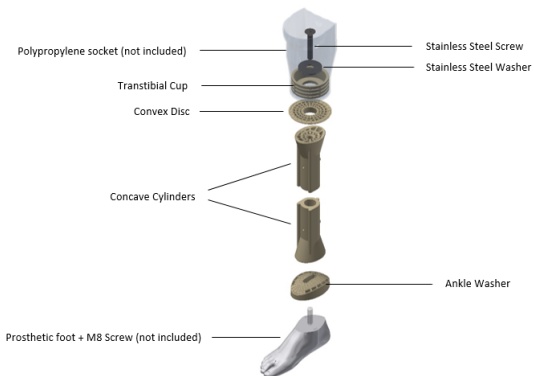

## Training

Please follow the ICRC manufacturing guidelines for transtibial prosthesis:

<https://www.icrc.org/en/doc/assets/files/other/eng-transtibial.pdf>

## Storage/handling

- Store product in dry conditions
- Store at room temperature (ideally between 15°C and 25°C)

- Keep out of direct sunlight or other sources of light with a high UV content
- Take precautionary measures against sparking and fire
- Keep in original packaging before use

## Environmental conditions

Recommended environmental conditions:

- Temperature range for use : -10°C to 60°C (14°F to 140°F)
- Relative humidity 0% to 90%, no condensing situation
- Avoid exposure to dust, sand, salt water, acids and urine

## Included in delivery

- 1x Transtibial Cup (TTA/TTC/TFC/LS)
- 1x Convex disc
- 2x Concave cylinder, M8, child
- 1x Convex ankle washer, child
- 1x Screw, countersunk head, FT, SS, M8x60
- 1x Flat washer, SS, 10.5/40/1.5

## Device manufacturing and setup guidelines

### *Socket manufacturing*

The Transtibial Cup is used during the manufacturing of the transtibial socket as indicated in the [manufacturing guidelines](#). It is important to place and align the cup correctly before proceeding with the manufacturing of the socket.

The Transtibial Cup is held in place with plaster at the distal end of the soft socket, with the positive cast in initial flexion, abduction or adduction according to the alignment of the assessed residual limb. This Transtibial Cup is used as a reinforcement and connection between the socket and the alignment system.

*Concave cylinders cutting to length and welding*



Cut the concave cylinders to the required length, remembering to allow an additional 5 mm for the material exuded in the welding process for each cylinder. Check that the cut is perpendicular to the vertical axis of the cylinder to allow for straight alignment of the shank assembly.

The cylinders are welded together using a mirror welder. Make sure that cylinders are well aligned during the welding and cooling stages to obtain a perfectly straight assembly.



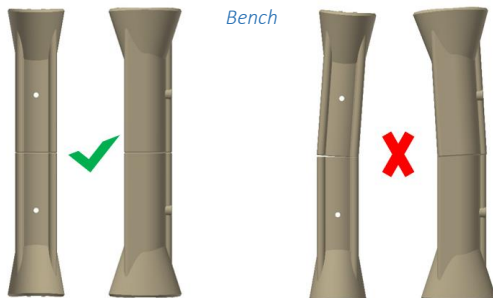

*alignment*

The socket, both welded concave cylinders and the prosthetic foot are assembled using the remaining parts of the kit and dedicated screws using the correct tools. Pay attention to the orientation of the concave cylinders in the sagittal plane (see illustration below).



Alignment changes can be applied to the proximal and/or to the distal end of the assembly:

- 1) Socket assembly (Transtibial Cup, Convex Disc, upper Concave Cylinder):

medial-lateral and anterior-posterior translation

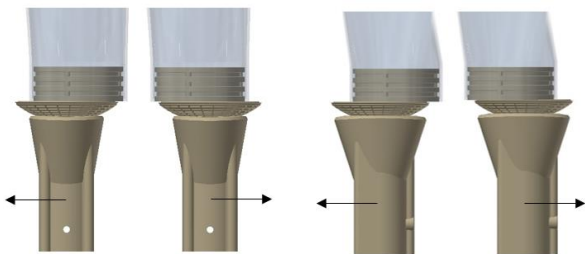

adduction-abduction and flexion-extension

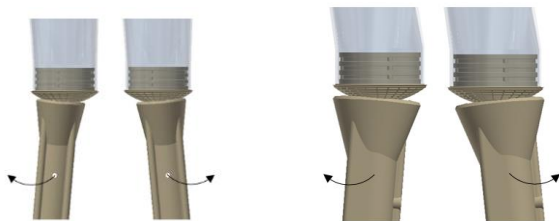

The system allows a tilting angle of maximum 10° in all directions.

Rotation

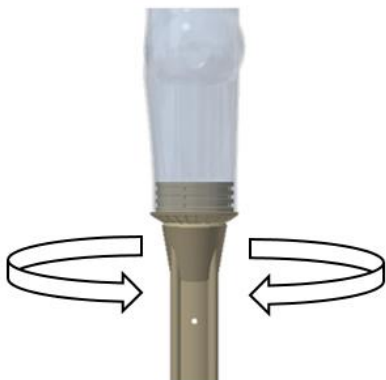

The system allows for a total freedom in rotation.

- 2) Ankle assembly (Foot, Ankle Washer, lower Concave Cylinder) which allows:

- plantar flexion-dorsiflexion, inversion-eversion



- rotation



The system allows for a total freedom in rotation.

**IMPORTANT: The Bench alignment should be done according to the user's shoes before fitting.**

The aim is to align the pylon vertically. The alignment can be adjusted for heel heights between 0mm and 20mm, but a heel height of 10 mm is recommended.

**The M8x80 screw must be tightened to 20Nm once the bench alignment is done.**



### *Static Alignment*

Static alignment should be verified with the user standing in upright position, with both shoes flat on the floor and with his/her weight equally distributed on both legs. For more security, alignment verification is recommended to be done with the user standing between parallel bars.

### *Dynamic alignment*

Observe the users gait between parallel bars. Check for a smooth transition from heel strike to toe-off. Make sure that the socket flexion is accurate to allow physiological full knee extension.

*Final welding before polypropylene cosmetic cover manufacturing*

**IMPORTANT: Welding the polypropylene components ensures proper performance over the lifetime of the prosthetic leg and is a mandatory step before proceeding with the polypropylene cosmetic cover manufacturing.**

For the final welding of polypropylene parts refer to the [manufacturing guidelines](#).

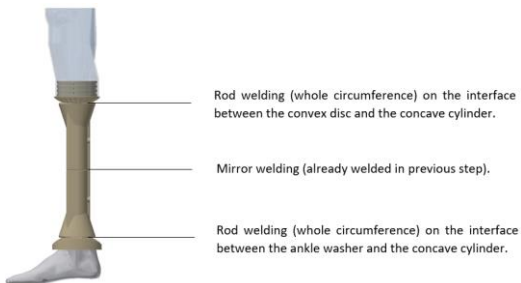

**IMPORTANT: the polypropylene cosmetic cover is part of the prosthetic leg and ensures proper performance; the components must not be used without it.**

Below is an example of a final product including the polypropylene cosmetic cover.



For the polypropylene cosmetic cover manufacturing refer to the [manufacturing guidelines](#).

## Maintenance

This device is designed for low maintenance. The prosthetic component should be inspected after the first 30 days of use. After this period it is recommended to inspect the device at least every six months for signs of unusual wear. If the device is used in a corrosive environment or subjected to excessive moisture, this period shall be shortened.

## Cleaning and care

This device can be cleaned using mild soap or solvent followed by rinsing with water. Allow device to dry completely before use. Avoid strong acid (pH=4 or less) and oxidizing agents.

This device has been engineered for a service life of 2-3 years depending on user's activity level. Scheduling of regular maintenance lies within the discretion of the service provider. The user shall discontinue use and report to the service provider in the event of any breakage, failure, change in function, or any unusual wear.



## Disposal

Users are advised to return defective or worn out products to their clinician. Please note that disposal of this product with regular domestic waste may not be permitted in all countries of use. Not following the disposal regulations of the responsible authorities may have a detrimental impact on health and environment.



Polypropylene is a recyclable polymer, dispose accordingly.

## Reusability

This device is intended for single-use only.

## Compatibilities

The Transtibial Alignment Kit, Child is compatible with the Rehab'Impulse Prosthetic Foot SACH 2.0, Child – Sizes 14 to 21

## Spare parts

Please contact manufacturer.

## Warnings, precautions

Using the product without following these instructions for use may cause injury or harm to the user and/or damage the product. This device shall be fitted by trained prosthetists only. Ensure that the approved service life is not exceeded. Do not expose the product to environmental conditions other than the one specified in this instruction. If damage is apparent or in case of doubt, do not continue using the product. Take suitable measures as required (e.g. cleaning, repair, replacement by trained P&O personal). In case of contact with salt water, acid, abrasive substances or any substance identified above, promptly clean the product in accordance with the chapter "Cleaning and Care".

## Compliance

This alignment kit has been tested according to the ISO 10328:2016 standard to 3 million load cycles. Please note that the kit has been tested within a complete prosthesis including a hard shell polypropylene cosmetic cover as stipulated in the above mentioned standard.

This kit is approved for a body weight of up to 60 kg (P3)  
Depending on the user's activity level, this corresponds to a service life of three to five years. It is recommended to carry out regular safety checks.

## CE Conformity

This product meets the requirements of the EU MDR 2017-745 guidelines for medical products. It has been classified as a Class I product according to the classification criteria outlined in Appendix VIII of the guidelines.

## Item codes

REF	Description English
74-00221	Transtibial Alignment Kit, Child

## IFU ID and date

IFU-TTC-EN-V1.0 – 21.11.2023



Fondation Alfaset  
Rue des Terreaux 48  
CH-2300 La-Chaux-de-Fonds  
Switzerland  
+41 32 967 96 50  
[www.alfaset.ch](http://www.alfaset.ch)  
[contact@alfaset.ch](mailto:contact@alfaset.ch)

